



- Energy Rating - D
- Two Bedrooms
- Kitchen
- No Onward Chain

- Semi Detached Bungalow
- 17ft X 11ft Lounge
- Bathroom
- In Need Of Refurbishment

Offered to the market with no onward chain, this two-bedroom semi-detached bungalow presents an excellent opportunity for buyers looking to put their own stamp on a home.

The accommodation is well proportioned throughout and comprises a good size lounge, a separate kitchen, two generous double bedrooms, and a bathroom. While the property now requires modernisation, it offers a solid layout and plenty of scope to update, extend, or reconfigure, subject to the necessary consents.

A particularly useful feature is the basement level, currently used as a workshop, providing valuable additional space ideal for storage, hobbies, or further development potential. The split-level rear garden adds character and offers the chance to create a private outdoor retreat with thoughtful landscaping.

Further benefits include gas central heating via a combination boiler and the advantage of no onward chain, allowing for a straightforward purchase.

This is a fantastic opportunity for downsizers, investors, or anyone seeking a bungalow with genuine potential in a popular and established location.

Lounge 17'3" max x 11'1" max (5.27 max x 3.39 max)

Kitchen 6'11" x 4'3" (2.11 x 1.31)

Utility 9'6" x 5'3" (2.92 x 1.62)

Bedroom One 11'3" x 10'10" (3.45 x 3.32)

Bedroom Two 11'3" x 11'0" (3.44 x 3.37)

Bathroom 10'11" max x 6'5" max (3.35 max x 1.96 max)

Workshop 16'2" max x 5'6" max (4.95 max x 1.68 max)

Tenure - Freehold

Council Tax - Band C









Bishopsworth Road, Bristol, BS13

Approximate Area = 668 sq ft / 62 sq m
 Outbuilding = 73 sq ft / 6.7 sq m
 Total = 741 sq ft / 68.7 sq m
 For identification only - Not to scale

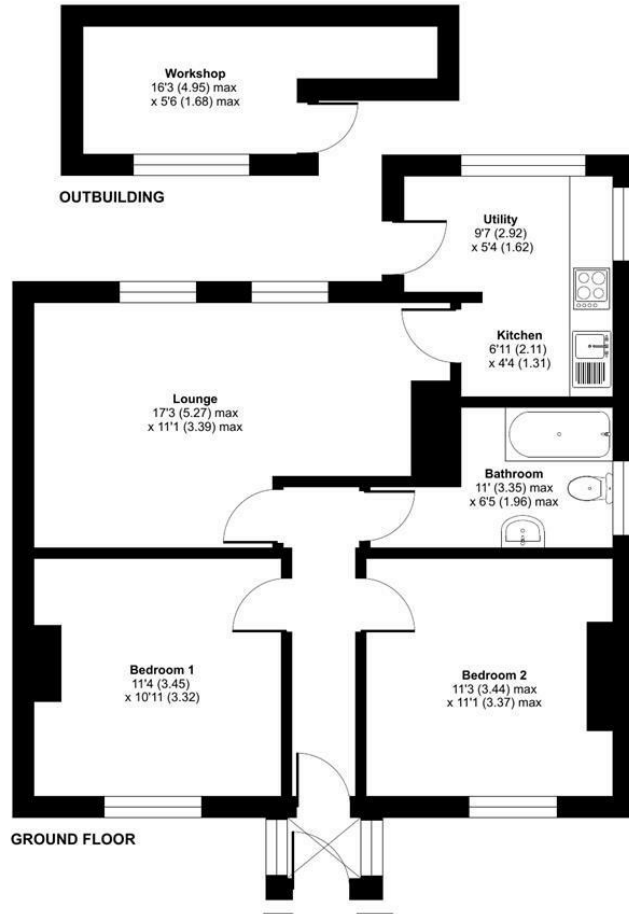

Floor plan produced in accordance with RICS Property Measurement 2nd Edition, Incorporating International Property Measurement Standards (IPMS2 Residential). © nichecom 2025. GREENWOODS SALES • LETTINGS • COMMERCIAL

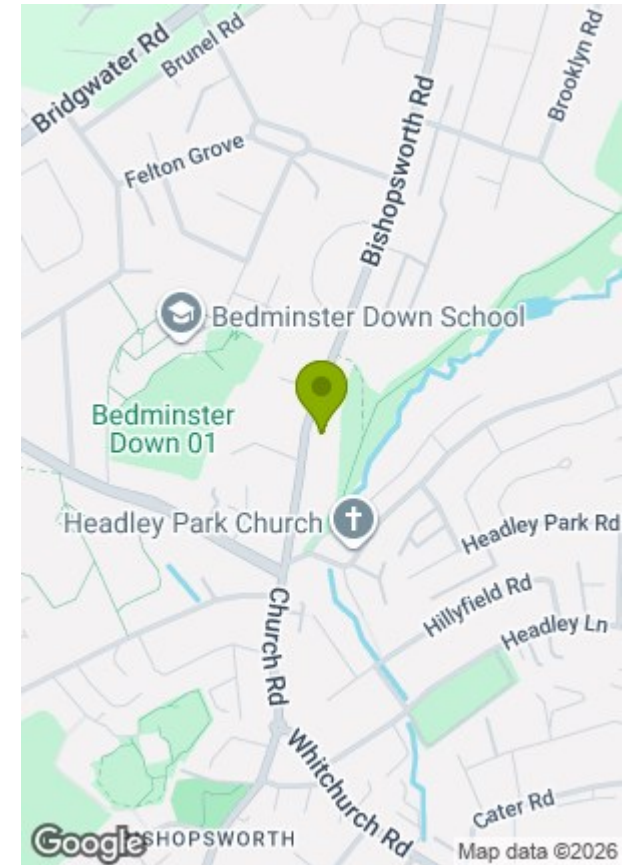

| Energy Efficiency Rating | | Environmental Impact (CO ₂) Rating | |
|---|-----------|---|-----------|
| Current | Potential | Current | Potential |
| | | | |
| Very energy efficient - lower running costs | | Very environmentally friendly - lower CO ₂ emissions | |
| (92 plus) A | | (82 plus) A | |
| (81-91) B | | (81-91) B | |
| (69-80) C | | (69-80) C | |
| (55-68) D | | (55-68) D | |
| (39-54) E | | (39-54) E | |
| (21-38) F | | (21-38) F | |
| (1-20) G | | (1-20) G | |
| | 65 | | |
| | 79 | | |
| Not energy efficient - higher running costs | | Not environmentally friendly - higher CO ₂ emissions | |
| England & Wales | | England & Wales | |
| EU Directive 2002/91/EC | | EU Directive 2002/91/EC | |

These particulars, whilst believed to be accurate are set out as a general outline only for guidance and do not constitute any part of an offer or contract. Intending purchasers should not rely on them as statements of representation of fact, but must satisfy themselves by inspection or otherwise as to their accuracy. No person in this firm's employment has the authority to make or give any representation or warranty in respect of the property.